

City of
Belvidere



DocId:6103282

Tx:4087388

2025R03515

LAURA BETTIS

CHIEF DEPUTY CLERK BOONE COUNTY IL

RECORDED ON

08/20/2025 09:33 AM

Number of Pages: 13

REC FEE 49.00

August 20, 2025

I, Erica Bluege, Belvidere City Clerk, hereby certify that the attached is a true and accurate copy of Ordinance #732H – An Ordinance Annexing Certain Territory Lying North of US Business Route 20, and East of Beaver Valley Road Consisting of Final Plats 1 & 2 of the Deer Hills Subdivisions to the City of Belvidere, Boone County, Illinois.

Erica Bluege

City Clerk

City of Belvidere, Illinois

Prepared By and Return To:

Erica Bluege, City Clerk

401 Whitney Blvd.

Belvidere, IL 61008

CITY OF BELVIDERE, ILLINOIS

ORDINANCE #732H

AN ORDINANCE ANNEXING CERTAIN TERRITORY LYING NORTH OF US BUSINESS ROUTE 20, AND EAST OF
BEAVER VALLEY ROAD CONSISTING OF FINAL PLATS 1 & 2 OF THE DEER HILLS SUBDIVISIONS TO THE CITY
OF BELVIDERE, BOONE COUNTY, ILLINOIS

PASSED AND ADOPTED

BY THE CITY COUNCIL

OF THE CITY OF

BELVIDERE, ILLINOIS

ON THE 18TH DAY OF AUGUST 2025.

APPROVED BY THE

MAYOR OF THE CITY OF

BELVIDERE, ILLINOIS

ON THE 19TH DAY OF AUGUST 2025.

Published in Pamphlet Form this 19th day of August 2025.

ORDINANCE #732H
AN ORDINANCE ANNEXING CERTAIN TERRITORY
LYING NORTH OF US BUSINESS ROUTE 20, AND
EAST OF BEAVER VALLEY ROAD CONSISTING OF
FINAL PLATS 1 & 2 OF THE DEER HILLS SUBDIVISIONS
TO THE CITY OF BELVIDERE, BOONE COUNTY, ILLINOIS

WHEREAS, written petitions signed by the legal owners of record of all land within the territory described in the attached Exhibit A (the Territory), has been filed with the City Clerk of the City of Belvidere, Boone County, Illinois, (the City) requesting that said Territory be annexed to the City of Belvidere; and

WHEREAS, at least 51% electors residing in the Territory and all owners of record of land within the Territory have executed Petitions to Annex the Territory to the City; and

WHEREAS, the Territory is not within the corporate limits of any municipality and the Territory is contiguous to the City; and

WHEREAS, section 7-1-8 of the Illinois Municipal Code (65 ILCS 5/7-1-8) authorize municipalities to annex contiguous territory upon the written petition signed by the owners of record and at least 51% of the electors residing in the territory; and

WHEREAS, legal notices regarding the annexation of the Territory have been sent to all public bodies required to receive such notice by State statute; and

WHEREAS, all petitions, documents and other legal requirements are in full compliance with the statutes of the State of Illinois; and

WHEREAS, the Territory is contiguous to Ward 2 of the City of Belvidere; and

WHEREAS, the is subject to an annexation agreement executed June 15, 2005 and approved by Ordinance 724G; and

WHEREAS, the Territory was rezoned in 2005 pursuant to ordinances 725G, 726G, 727G, 728G, and 806G (the Zoning Ordinances) and such zoning shall continue for the Territory upon annexation as well as all variances, special use ordinances and other actions taken by the City subsequent to adoption of Ordinance 724G; and

WHEREAS, it is in the best interest of the City that the Territory be annexed.

NOW THEREFORE, be it ordained by the Mayor and City Council of the City of Belvidere, Boone County Illinois, as follows:

SECTION 1: The foregoing recitals are incorporated herein by this reference.

SECTION 2: The Territory described in the attached Exhibit A, which is incorporated herein by this reference, and which is further described in the Plat of Annexation attached as Exhibit B, which is also incorporated herein by

this reference, is hereby annexed to the City of Belvidere, Boone County, Illinois.

SECTION 3: Notwithstanding any other provision of the Belvidere Municipal Code, the Territory shall maintain the zoning and planned unit developments approved by the Zoning Ordinances.

SECTION 4: The annexed Territory is hereby incorporated into and made a part of Ward 2 of the City of Belvidere and the boundaries of Ward 2 shall be adjusted accordingly.

SECTION 5: The City Clerk of the City of Belvidere is hereby directed to immediately record, with the Recorder of Deeds for Boone County, Illinois, and file with the Boone County Clerk, a certified copy of this Ordinance, together with the accurate map of the Territory annexed and appended to the Ordinance as Exhibit A. The City Clerk shall also file the affidavit of service of the notices required by 65 ILCS 5/7-7-1 with the Boone County Recorder. The City Clerk shall also file a copy of this Ordinance with all other applicable agencies including but not limited to the Illinois Department of Revenue and the U.S. Postal Service.

SECTION 6: That all maps, journals and other records of the City be changed accordingly.

SECTION 7: If any section, paragraph, subdivision, clause, sentence or provision of this Ordinance shall be adjudged by any Court of competent jurisdiction to be invalid, such judgment shall not affect, impair, invalidate or nullify the remainder thereof, which remainder shall remain and continue in full force and effect.

SECTION 8: All ordinances or parts of ordinances in conflict herewith are hereby repealed to the extent of such conflict.

SECTION : This Ordinance shall be in full force and effect immediately upon its passage and approval.

Passed by the City Council of the City of Belvidere, Illinois this 18th day of August, 2025.

Approved:

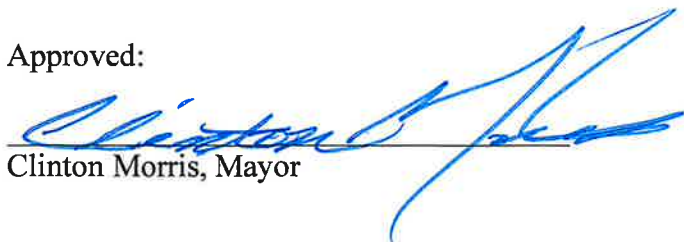

Clinton Morris, Mayor

Attest:

Erica Bluege, City Clerk

Ayes: Fleury, Frank, Gramkowski, Hoiness, McGee, Montalbano,
Peterson, Stevens, Albertini and Brereton.

Nays: None.

Absent: None.

Date Passed: August 18, 2025

Date Approved: August 19, 2025

Date Published: August 20, 2025

Prepared By / Return To:

Michael S. Drella

City Attorney

City of Belvidere

401 Whitney Blvd

Belvidere, Illinois 61008

EXHIBIT A

- 1) Lots 1-102, but excluding lots 23, 36, 87 and 88, as designated upon Plat No. 1 of Deer Hills Subdivision, being a Subdivision of part of the West Half (1/2) of the Southwest Quarter (1/4) of Section 16 and part of the West Half (1/2) of the Northwest Quarter (1/4) of Section 21, both located in Township 44 North, Range 3, East of the Third Principal Meridian, according to the Plat thereof recorded May 16, 2006, Plat index file envelope 349-B, as Document No. 2006R05230, In the Recorder's Office of Boone County, Illinois, situated in the County of Boone and the State of Illinois.
- 2) Lots 103 – 200 and out lots D & E, but excluding lots 132 and 201, as designated upon Plat No. 2 of Deer Hills Subdivision, being a Subdivision of part of the West Half of the Southwest Quarter of Section 16, Township 44 North, Range 3, East of the Third Principal Meridian, according to the Plat thereof recorded October 6, 2006, Plat Index File 359-B, as Document No. 2006R11070, In the Recorder's Office of Boone County, Illinois, situated in the County of Boone and the State of Illinois.
- 3) Annexed PINS:

Lot 1	05-21-104-001	252 BROCKET TRL
Lot 2	05-21-104-002	250 BROCKET TRL
Lot 3	05-21-104-003	246 BROCKET TRL
Lot 4	05-21-104-004	247 BROCKET TRL
Lot 5	05-21-104-005	249 BROCKET TRL
Lot 6	05-21-104-006	251 BROCKET TRL
Lot 7	05-21-104-007	4522 SPOTTED DEER TRL
Lot 8	05-21-104-008	4504 SPOTTED DEER TRL
Lot 9	05-21-104-009	4472 SPOTTED DEER TRL
Lot 10	05-21-104-010	4454 SPOTTED DEER TRL
Lots 11 and 12 (pin combo)	05-21-104-019	4436 SPOTTED DEER TRL
Lot 13	05-21-104-013	4390 SPOTTED DEER TRL
Lot 14	05-21-104-014	4368 SPOTTED DEER TRL
Lot 15	05-21-104-015	4346 RUSA TRL
Lot 16	05-21-104-016	4324 RUSA TRL
Lot 17	05-21-104-017	4300 RUSA TRL
Lots 18 and 19 (pin combo)	05-21-103-014	301 WHITETAIL TRL
Lots 20	05-21-103-011	307 WHITETAIL TRL
Lot 21	05-21-103-010	311 WHITETAIL TRL
Lot 22	05-21-103-009	315 WHITETAIL TRL
Lot 24	05-21-103-007	323 WHITETAIL TRL
Lot 25	05-21-103-006	327 WHITETAIL TRL
Lots 26 and 27 (replat)	05-21-103-015	331 WHITETAIL TRL

Lot 28	05-21-103-003	339 WHITETAIL TRL
Lot 29	05-21-103-002	341 WHITETAIL TRL
Lot 30	05-21-103-001	347 WHITETAIL TRL
Lot 31	05-16-352-008	349 WHITETAIL TRL
Lot 32	05-16-352-007	351 WHITETAIL TRL
Lot 33	05-16-352-006	353 WHITETAIL TRL
Lot 34	05-16-352-005	357 WHITETAIL TRL
Lot 35	05-16-352-004	361 WHITETAIL TRL
Lot 38	05-16-352-001	407 SAMBOR TRL
Lot 39	05-21-102-036	303 BROCKET TRL
Lot 40	05-21-102-037	4507 SPOTTED DEER TRL
Lot 41	05-21-102-038	4483 SPOTTED DEER TRL
Lot 42	05-21-102-039	4459 SPOTTED DEER TRL
Lot 43	05-21-102-040	4421 SPOTTED DEER TRL
Lot 44	05-21-102-041	4397 SPOTTED DEER TRL
Lot 45	05-21-102-042	4363 SPOTTED DEER TRL
Lot 46	05-21-102-043	4366 TUFTED DEER CT
Lot 47	05-21-102-035	4432 TUFTED DEER CT
Lot 48	05-21-102-034	4464 TUFTED DEER CT
Lot 49	05-21-102-033	4478 TUFTED DEER CT
Lot 50	05-21-102-032	4469 TUFTED DEER CT
Lot 51	05-21-102-031	4457 TUFTED DEER CT
Lot 52	05-21-102-030	4413 TUFTED DEER CT
Lot 53	05-21-102-029	4385 TUFTED DEER CT
Lot 54	05-21-102-028	4371 TUFTED DEER CT
Lot 55	05-21-102-027	4374 MANIPUR CT
Lot 56	05-21-102-026	4396 MANIPUR CT
Lot 57	05-21-102-025	4408 MANIPUR CT
Lot 58	05-21-102-024	4432 MANIPUR CT
Lot 59	05-21-102-023	4458 MANIPUR CT
Lot 60	05-21-102-022	4484 MANIPUR CT
Lot 61	05-21-102-021	4475 MANIPUR CT
Lot 62	05-21-102-020	4453 MANIPUR CT
Lot 63	05-21-102-019	4439 MANIPUR CT
Lot 64	05-21-102-018	4417 MANIPUR CT
Lot 65	05-21-102-017	332 WHITETAIL TRL
Lot 66	05-21-102-016	336 WHITETAIL TRL
Lot 67	05-21-102-015	342 WHITETAIL TRL
Lot 68	05-21-102-014	348 WHITETAIL TRL
Lot 69	05-21-102-013	356 WHITETAIL TRL
Lot 70	05-21-102-012	362 WHITETAIL TRL
Lot 71	05-21-102-001	368 WHITETAIL TRL
Lot 72	05-21-102-002	372 WHITETAIL TRL
Lot 73	05-21-102-003	341 BROCKET TRL
Lot 74	05-21-102-004	335 BROCKET TRL
Lot 75	05-21-102-005	329 BROCKET TRL
Lot 76	05-21-102-006	321 BROCKET TRL

Lot 77	05-21-102-007	319 BROCKET TRL
Lot 78	05-21-102-008	317 BROCKET TRL
Lot 79	05-21-102-009	313 BROCKET TRL
Lot 80	05-21-102-010	309 BROCKET TRL
Lot 81	05-21-102-011	305 BROCKET TRL
Lot 82	05-21-101-010	4597 SPOTTED DEER TRL
Lot 83	05-21-101-011	4575 SPOTTED DEER TRL
Lot 84	05-21-101-012	4559 SPOTTED DEER TRL
Lot 85	05-21-101-013	4541 SPOTTED DEER TRL
Lot 86	05-21-101-009	310 BROCKET TRL
Lot 89	05-21-101-006	322 BROCKET TRL
Lot 90	05-21-101-005	326 BROCKET TRL
Lot 91	05-21-101-004	330 BROCKET TRL
Lot 92	05-21-101-003	336 BROCKET TRL
Lot 93	05-21-101-002	338 BROCKET TRL
Lot 94	05-16-351-010	342 BROCKET TRL
Lot 95	05-16-351-009	4542 MUNTJAC TRL
Lot 96	05-16-351-008	4558 MUNTJAC TRL
Lot 97	05-16-351-007	4574 MUNTJAC TRL
Lot 98	05-16-351-006	4596 MUNTJAC TRL
Lot 99	05-16-351-005	4591 MUNTJAC TRL
Lot 100	05-16-351-004	4571 MUNTJAC TRL
Lot 101	05-16-351-003	4553 MUNTJAC TRL
Lot 102	05-16-351-002	4547 MUNTJAC TRL
Lot 103	05-16-352-018	473 SAMBOR TRL
Lot 104	05-16-352-009	4482 S VALLEY RIDGE DR
Lot 105	05-16-352-010	4464 S VALLEY RIDGE DR
Lot 106	05-16-352-011	4448 S VALLEY RIDGE DR
Lot 107	05-16-352-012	4440 S VALLEY RIDGE DR
Lot 108	05-16-352-013	4328 EASTRIDGE LN
Lot 109	05-16-352-014	4322 EASTRIDGE LN
Lot 110	05-16-352-015	4318 EASTRIDGE LN
Lot 111	05-16-352-016	4310 EASTRIDGE LN
Lot 112	05-16-352-017	4302 EASTRIDGE LN
Lot 113	05-16-354-011	4305 EASTRIDGE LN
Lot 114	05-16-354-010	4313 EASTRIDGE LN
Lot 115	05-16-354-009	4364 S VALLEY RIDGE DR
Lot 116	05-16-354-008	4356 S VALLEY RIDGE DR
Lot 117	05-16-354-007	4342 S VALLEY RIDGE DR
Lot 118	05-16-354-006	4338 S VALLEY RIDGE DR
Lot 119	05-16-354-005	4326 S VALLEY RIDGE DR
Lot 120	05-16-354-004	4371 N VALLEY RIDGE DR
Lot 121	05-16-354-003	4375 N VALLEY RIDGE DR
Lot 122	05-16-354-002	4381 N VALLEY RIDGE DR
Lot 123	05-16-354-001	4389 N VALLEY RIDGE DR
Lot 124	05-16-302-036	4393 N VALLEY RIDGE DR
Lot 125	05-16-302-035	4401 N VALLEY RIDGE DR

Lot 126	05-16-302-034	4405 N VALLEY RIDGE DR
Lot 127	05-16-302-033	4417 N VALLEY RIDGE DR
Lot 128	05-16-302-032	709 NORTHRIDGE CT
Lot 129	05-16-302-031	715 NORTHRIDGE CT
Lot 130	05-16-302-030	735 NORTHRIDGE CT
Lot 131	05-16-302-029	743 NORTHRIDGE CT
Lot 133	05-16-302-027	748 NORTHRIDGE CT
Lot 134	05-16-302-026	738 NORTHRIDGE CT
Lot 135	05-16-302-025	732 NORTHRIDGE CT
Lot 136	05-16-302-024	728 NORTHRIDGE CT
Lot 137	05-16-302-023	722 NORTHRIDGE CT
Lot 138	05-16-302-022	718 NORTHRIDGE CT
Lot 139	05-16-302-021	710 NORTHRIDGE CT
Lot 140	05-16-302-020	4445 N VALLEY RIDGE DR
Lot 141	05-16-302-019	4463 N VALLEY RIDGE DR
Lot 142	05-16-302-018	4477 N VALLEY RIDGE DR
Lot 143	05-16-302-017	4489 N VALLEY RIDGE DR
Lot 144	05-16-302-016	677 RED DEER TRL
Lot 145	05-16-302-015	681 RED DEER TRL
Lot 146	05-16-302-014	683 RED DEER TRL
Lot 147	05-16-302-013	685 RED DEER TRL
Lot 148	05-16-302-012	687 RED DEER TRL
Lot 149	05-16-303-001	4494 N VALLEY RIDGE DR
Lot 150	05-16-303-002	4484 N VALLEY RIDGE DR
Lot 151	05-16-303-003	4468 N VALLEY RIDGE DR
Lot 152	05-16-303-004	4456 N VALLEY RIDGE DR
Lot 153	05-16-303-005	4432 N VALLEY RIDGE DR
Lot 154	05-16-303-006	4420 N VALLEY RIDGE DR
Lot 155	05-16-303-007	4412 N VALLEY RIDGE DR
Lot 156	05-16-303-008	4396 N VALLEY RIDGE DR
Lot 157	05-16-303-009	4386 N VALLEY RIDGE DR
Lot 158	05-16-303-010	4433 DEER VALLEY CL
Lot 159	05-16-303-011	4465 DEER VALLEY CL
Lot 160	05-16-303-012	4471 DEER VALLEY CL
Lot 161	05-16-353-014	4488 DEER VALLEY CL
Lot 162	05-16-353-015	4482 DEER VALLEY CL
Lot 163	05-16-353-016	4456 DEER VALLEY CL
Lot 164	05-16-353-017	4442 DEER VALLEY CL
Lot 165	05-16-353-018	4430 DEER VALLEY CL
Lot 166	05-16-353-019	4374 N VALLEY RIDGE DR
Lot 167	05-16-353-020	4333 S VALLEY RIDGE DR
Lot 168	05-16-353-021	4431 TREEVIEW CL
Lot 169	05-16-353-022	4453 TREEVIEW CL
Lot 170	05-16-353-023	4475 TREEVIEW CL
Lot 171	05-16-353-024	4481 TREEVIEW CL
Lot 172	05-16-353-025	4486 TREEVIEW CL
Lot 173	05-16-353-026	4480 TREEVIEW CL



Lot 174	05-16-353-027	4468 TREEVIEW CL
Lot 175	05-16-353-028	4446 TREEVIEW CL
Lot 176	05-16-353-013	4361 S VALLEY RIDGE DR
Lot 177	05-16-353-012	4377 S VALLEY RIDGE DR
Lot 178	05-16-353-011	4435 S VALLEY RIDGE DR
Lot 179	05-16-353-010	4453 S VALLEY RIDGE DR
Lot 180	05-16-353-009	4479 S VALLEY RIDGE DR
Lot 181	05-16-353-008	527 RED DEER TRL
Lot 182	05-16-353-007	541 RED DEER TRL
Lot 183	05-16-353-006	553 RED DEER TRL
Lot 184	05-16-353-005	569 RED DEER TRL
Lot 185	05-16-353-004	587 RED DEER TRL
Lot 186	05-16-353-003	609 RED DEER TRL
Lot 187	05-16-353-002	627 RED DEER TRL
Lot 188	05-16-353-001	643 RED DEER TRL
Lot 189	05-16-351-023	514 RED DEER TRL
Lot 190	05-16-351-022	536 RED DEER TRL
Lot 191	05-16-351-021	548 RED DEER TRL
Lot 192	05-16-351-020	564 RED DEER TRL
Lot 193	05-16-351-019	570 RED DEER TRL
Lot 194	05-16-351-018	584 RED DEER TRL
Lot 195	05-16-351-017	606 RED DEER TRL
Lot 196	05-16-351-016	632 RED DEER TRL
Lot 197	05-16-351-015	650 RED DEER TRL
Lot 198	05-16-351-014	662 RED DEER TRL
Lot 199	05-16-351-013	674 RED DEER TRL
Lot 200	05-16-351-012	678 RED DEER TRL
Outlot D	05-16-352-019	
Outlot E	05-16-302-011	
Lot 37	05-16-352-002	369 WHITETAIL TRL

EXHIBIT B



1 inch = 364 feet

Plat of Annexation Deer Hills I and Deer Hills II

 Excluded from Annexation
 Annexation Boundary

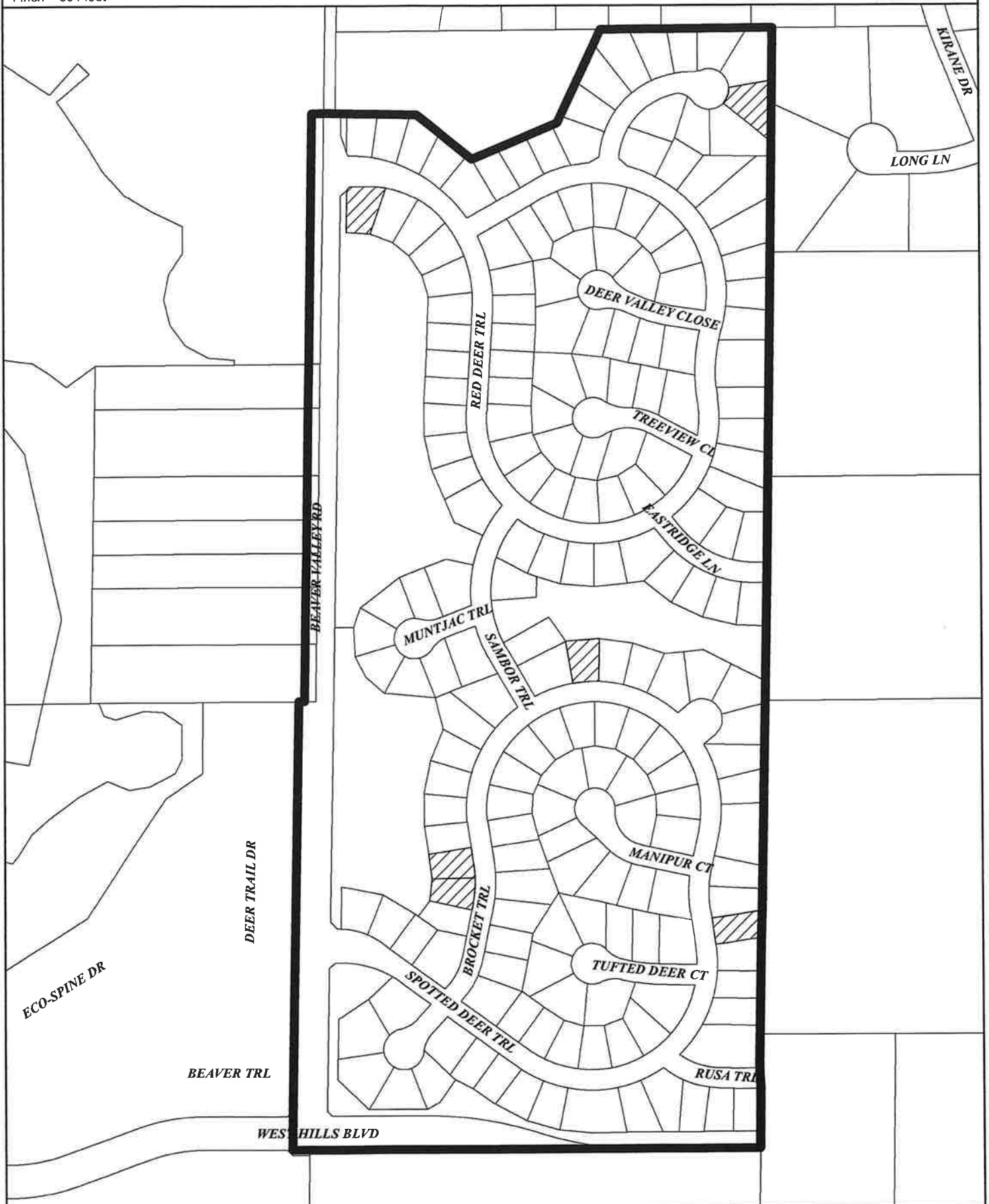

AFFIDAVIT

STATE OF ILLINOIS)
)
COUNTY OF BOONE)

Erica Bluege, first being duly sworn on oath deposes and says as follows:

By authority of the City Council of the City of Belvidere, Illinois, I published Ordinance #732H of the City of Belvidere, Illinois, in pamphlet form on August 20, 2025 and as a convenience for the public; I posted the pamphlet form of Ordinance #732H on the bulletin board in the lobby of Belvidere City Hall at 401 Whitney Blvd., Belvidere, Illinois; said location being readily accessible to the public during business hours of the City Clerk's office.



Erica Bluege
City Clerk

SUBSCRIBED AND SWORN TO BEFORE ME

this 20th day of Aug, 2025.

Notary Public